

*** Warnings ***

Rocky's Reel Systems Inc. reserves the right to make any modifications to the products at any time without prior notice, and rejects any liability for any kind of damage to persons or property due to improper installation, use or misuse.

Before starting the installation of this kit, we recommend that you carefully read these instructions to familiarize yourself with the installation and programming of this unit. These instructions are intended for qualified technicians in the field of automation. The information contained in these instructions may not be useful to unqualified individuals.

All maintenance or adjustment operations should be carried out by a qualified technician.

FOLLOW ALL LOCAL ELECTRICAL SAFETY PRECAUTIONS. DO NOT CHARGE IN WET CONDITIONS. USE A PROPER POWER SOURCE THAT IS ON A GFI. ROCKY'S RECOMMENDS CHARGING YOUR MOTOR AWAY FROM THE POOL. ROCKY'S REEL SYSTEMS INC. IS NOT RESPONSIBLE FOR ANY INJURY OR DAMAGE RESULTING FROM MISUSE OF ELECTRICITY OR THE 3" MOTOR KIT.

Certificate of Conformity (Directive 2006/42/EEC,-IIA)

The automation outlined in this document must be performed in accordance with the current regulatory systems.

-Safety of machinery. Electrical equipment. Part 1 General rules.

-Safety in the use of automated materials, test method and test.

-Safety of pool materials and electrical protection.

Installation requires a working knowledge of electricity and mechanics. It must be done exclusively by a qualified technician and by an individual authorized to deliver the certificate of conformity by the installation.

(Directive 2006/42/EEC, -IIA)

It is obligatory to conform to the norms of use of the materials on the edge of basins of water or swimming pools.

The manufacturer reserves the right to make any changes at any time to the product without prior notice.

1 Remove The Standard Hub

Remove the two TEK screws on the handle side of your reel that secure the hub to the tube. The motor unit will be replacing the hub.

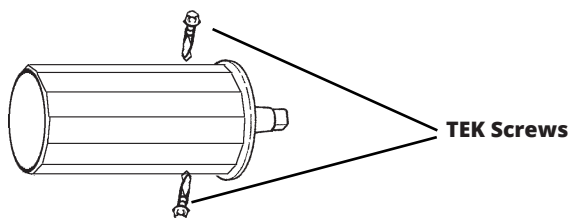

Next slide the hub out of the tube. Put the two TEK screws and the hub some place safe so that if you need them in the future you still have them.

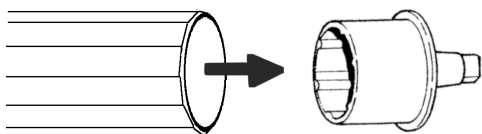

2 Insert The Motor Assembly



Next slide the motor into the tube. The motor should slide in easily, if it catches do not force it in. Make sure your are sliding it in as straight as possible.



3 Securing The Motor

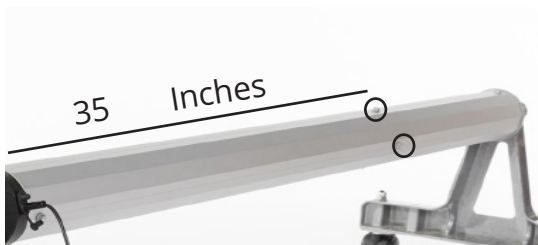

Next you will need to lay out where you will attach the motor. You will need to measure **35** inches down 3 sides of the tube and make a mark where you will put the screws in. Rocky's recommends using the sides that have the screw channels so that your screws will be centered. Once you have laid out where the screws will go, use a number 2 Phillips driver bit to secure the motor with the three supplied TEK screws.

4 Reassemble The Reel System

Put the black bushing onto the end of the motor, we recommend putting some waterproof grease inside the bushing. Grease once a year after that.

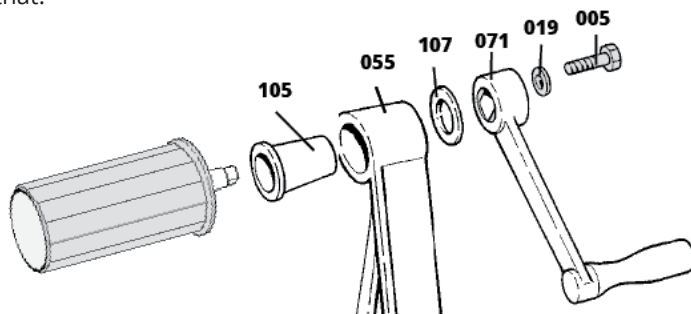

Push the motor and the black bushing into the frame. Put the black washer over the end of the protruding end of the motor and slide the handle onto the end. Put the 5/16" washer on the bolt and secure the handle. **VERY IMPORTANT:** Do not over-tighten this bolt as it will make it hard to rotate the handle.

5

Installing The Lock Pin

Now you will need to layout and drill a 5/16" hole through the frame, the bushing and the shaft of the motor. This hole will be used to put a pin through to keep the handle from spinning while the motor is operating. To ensure that the hole lines up you will have to drill it while the motor is in the frame. To layout the hole measure an inch from the inside edge of the frame and an inch from the top of the frame. Mark your hole and drill it. When it is complete put the included lock pin through for when the motor is in use. To operate the reel manually you simply have to remove the lock pin and the handle will turn normally.

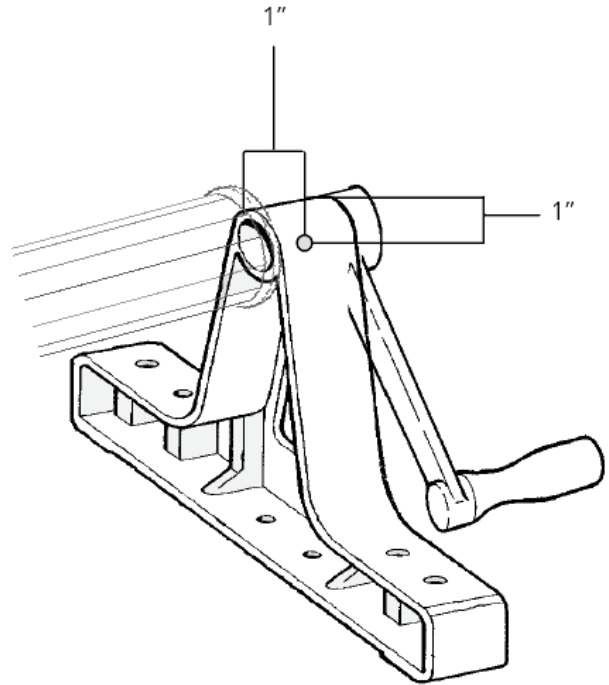

6

Programming The Remote

1. Release the lock pin so you don't damage the motor while programming the remote.
2. To enter Learning Mode hold the button on the motor for 5 seconds until the motor makes a small movement.
3. Next press and hold Button 1 on the remote until the motor starts turning. Caution at this point as it is possible that the motor will start spinning.
4. Button 1 will now turn the motor one direction and Button 3 will turn it the opposite direction.

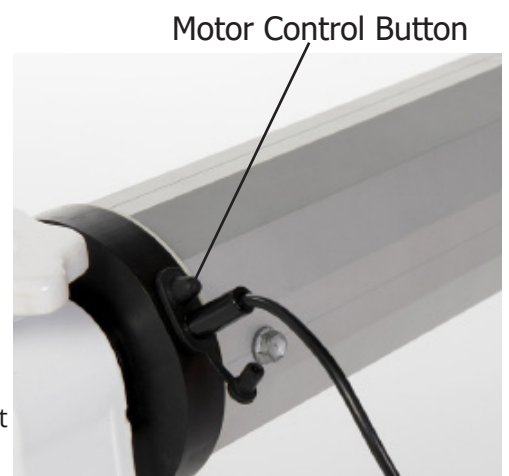

5. If you want the buttons to be reversed repeat steps 2 and 3 but press and hold Button 3 instead of 1. This can be useful if you are programming multiple motors to work in unison.
6. The motor stops by pressing either of the two movement buttons.
7. The buttons are programmed in groups. Odd numbers (1 and 3) and even numbers (2 and 4).
8. Now that the remote is programmed you can put the lock pin back in.

7

Operation

Motor Movement

If the remote stops working it is possible to operate the motor using the button by the charge port. Press the button once to start movement. If you need to reverse direction press the button again and it will stop. Press it a second time and it will reverse direction. If the battery loses its charge you can still operate the reel manually by removing the lock pin.

Safe Mode

If the battery loses its charge the motor places itself in Safe Mode where it locks the gears to protect the motor. To remove Safe Mode recharge the battery. In Safe Mode the lock pin can be removed and the reel used manually.

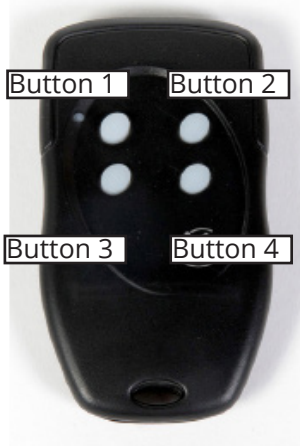

Standby Mode

This mode extends the life of the batteries. Ten minutes after the last movement made the motor automatically enters Standby Mode. To exit Standby Mode you will have to push the button on the motor. The motor will move slightly to signify that it is active. The remote is now activated.

If you are attaching a solar panel you will first need to attach the panel and then shut off Standby Mode by pressing the motor button three times and then holding it for five seconds.

Motor Control Button



8

Charging and Maintenance

Charger Connection and Duration of Charge

Connect the charger to the port next to the button on the motor.

The charging time from when the battery is completely dead to full charge is estimated to be 10 hours. The electronics automatically regulate the charging current to ensure the longest battery lifespan.

The estimated use on a full charge is approximately 1 hour of use a week for 3 to 4 weeks. That translates to pulling your cover on and off 8 times per week. If there is insufficient battery charge during that time the motor will place itself in Safe Mode until it is recharged.

It is essential to only use the supplied charger. Any other charger could destroy the life of the batteries.

If you require a replacement charger contact Rocky's for information on where to purchase.

Winter Storage

It is recommended not to leave the battery in temperatures below minus 5° Celsius (23° Fahrenheit).

It is imperative that you store the motor during the winter in order to ensure correct operation and warranty guarantees.

Fully charge the battery before storing it. We recommend 12 hours to ensure a maximum charge. If you need to remove the unit from the reel for storage simply undo the three screws in the tube and slide the motor out. When you put the motor back into service after winter, recharge the battery fully the night before use.

Replacing The Batteries

Changing the battery should only be done by a qualified professional. Only the batteries recommended by the manufacturer should be used otherwise you will void your warranty.

Motor Control Button



9

Parts Included and Tools Required

ITEM #	QTY.	DESCRIPTION	RE-ORDER #
1	1	Motor Assembly	300
2	3	Phillips TEK Screws	300
3	1	Remote	300
4	1	Power Supply	300
5	1	Lock Pin	701
6	1	EU Power Adaptor	702

Tools Required

Reversible Electric Drill
#2 Phillips Driver Bit
Tape Measure
Pencil
1/2" Wrench
5/16" Driver Bit

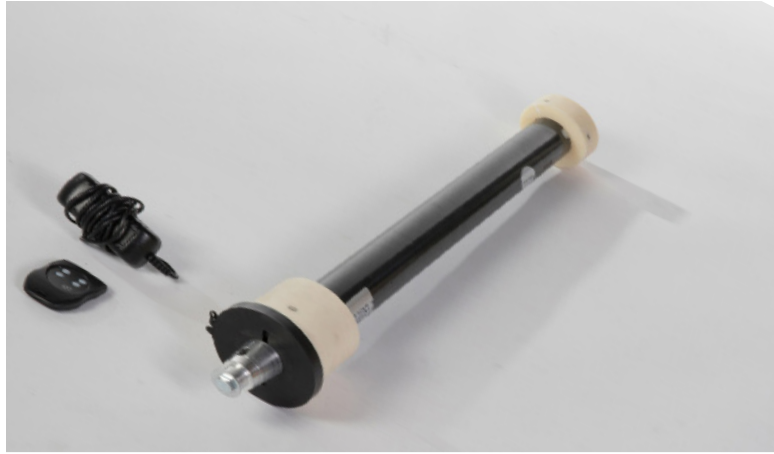

10

Technical Information

Rocky's 3" Motor Kit features a 20 Nm Motor and battery assembly that can be easily fitted into any of Rocky's existing 3" Reel Systems.

- The motor provides 20 Nm of force per second which translates to 14.76 Foot Pounds a second
- The remote has a range of over 75 yards
- The battery is a LiFe Po4 it supplies 12 volts at 3 amperes
- The battery supplies 3 Watt Hours
- Charge time is approximately 10 hours
- One motor can operate a 12 mil solar cover on a pool up to 20'x40'
- Two motors can be paired (one in each end and running opposite) to operate on larger pools
- Can be installed in both portable and permanent systems



For information regarding warranty, installation or operation of Rocky's 3" Motor Kit please contact the team at Rocky's via one of the following options.

Email: info@rockys.ca

Phone: 1-800-663-8705

Website: www.rockys.ca